

**SIDE VIEW**

Not To Scale

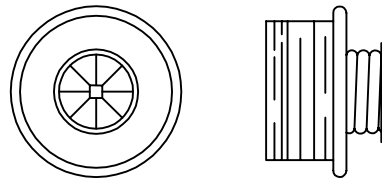

**DETAIL 'A'  
EXPANDABLE STOPPER**

Not To Scale

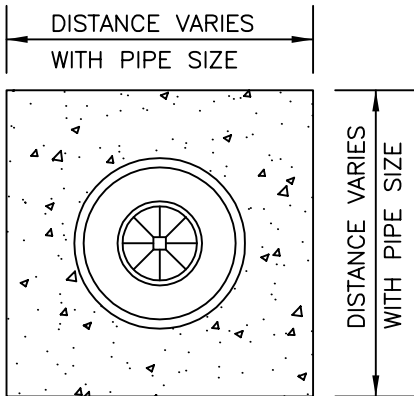

**TOP VIEW**

Not To Scale

**NOTES:**

1. Mission PG 308, ETCO Expandable Stopper, or Equal.

The City Of Okla.  
401 West Oklahoma  
P.O. Box 1788  
Edmond, Oklahoma 73116  
Telephone: (405) 234-2000 Fax: (405) 234-8948

**Contacts:**

Robert Hill, Director of Engineering Services, Ext. 344  
Jason Brinkley, Civil Engineer, Ext. 348



The City Of Okla., Oklahoma

REVISIONS	
Number	Description

Project Number:	Project Location:
STANDARD GROUND MOUNT SANITARY SEWER CONNECTION	SWD - 12
Sheet Title:	Project Title:



Date:	6/1/00
Scale:	NO SCALE
Cad File:	G:\DATA\SPEDS\SWD12
Drawn By:	P.B./C.L.H.
Designed By:	R.H.
Approved By:	R.H.
Sheet:	of