

▲ IF CONCRETE PIPE OPTION IS USED THE LENGTH OF PIPE TO BE REDUCED BY "C" DIMENSION FOR EACH END SECTION.

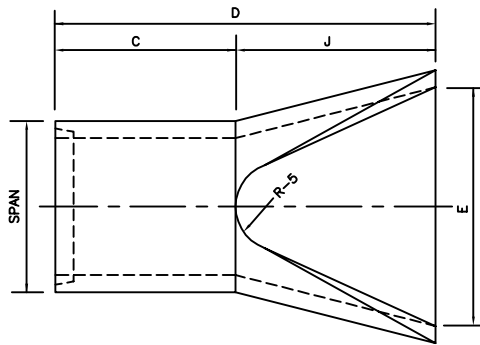

PLAN VIEW

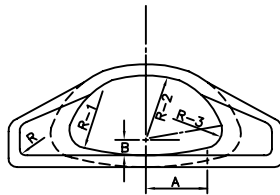

END VIEW
ARCH PIPE
END SECTION

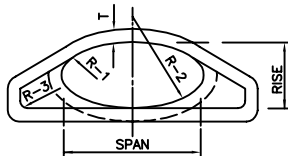

END VIEW
ELLIPTICAL CONC.
END SECTION

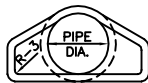

END VIEW
ROUND CONC. PIPE END SECTION

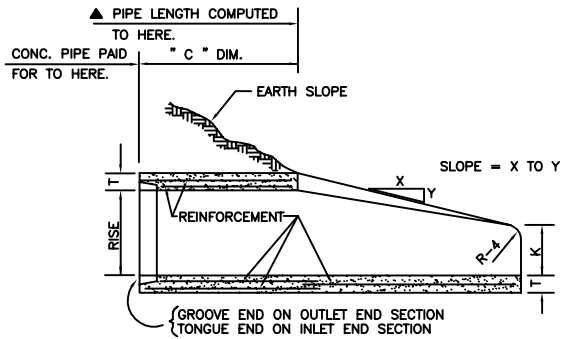

LONGITUDINAL SECTION

NOTE: See Storm Sewer Pipe Coupler Detail DD-19, Sht. 1.

DIMENSIONS OF PRECAST END SECTION FOR ARCH-PIPES																
SPAN	RISE	A	B	R	R ₁	R ₂	R ₃	R ₄	R ₅	T	K	J	C	D	E	SLOPE
IN.	IN.	IN.	IN.	IN.	IN.	IN.	IN.	IN.	IN.	IN.	IN.	IN.	IN.	IN.	IN.	
28 1/2	18	10 1/2	3 1/2	3	40 1/2	14 1/2	4 3/8	3	7	3 1/2	8 1/2	39	33	72	48	3 to 1
36 1/2	22 1/2	13 3/8	3 1/8	3	51	18 1/2	6 3/8	3	8	4	9 1/2	50	46	96	60	3 to 1
43 1/2	26 3/8	17 3/8	4 1/8	6	62	22 1/2	6 1/2	3	10 1/2	4 1/2	11 1/2	60	36	96	72	3 to 1
51 1/2	31 3/8	20	5 1/8	6	73	26 1/2	7 1/2	3	12 1/2	4 1/2	15 1/8	60	36	96	78	3 to 1
58 1/2	36	22 3/4	6	6	84	30	8 3/4	3	14	5	21	60	36	96	84	3 to 1
65	40	25	6 3/4	6	92 1/2	33 1/2	10	6	16	5 1/2	25 1/2	60	36	96	90	3 to 1
73	45	28 1/2	7 1/2	6	105	37 1/2	11 1/8	6		6	31	60	36	96	96	3 to 1

DIMENSIONS OF PRECAST END SECTION FOR ELLIPTICAL PIPES													
SPAN	RISE	R ₁	R ₂	R ₃	R ₄	R ₅	T	K	J	C	D	E	SLOPE
IN.	IN.	IN.	IN.	IN.	IN.	IN.	IN.	IN.	IN.	IN.	IN.	IN.	
23	14	6	20	3	3	6	2 1/2	8	27	45	72	36	3 to 1
30	19	8 1/2	26 1/2	3	3	7	3 1/2	8 1/2	39	33	72	48	3 to 1
38	24	10 1/2	32 1/2	3	3	9 1/2	3 1/2	9 1/2	54	18	72	60	3 to 1
45	29	12 1/2	39 1/2	3	3	12	4 1/2	11 1/2	60	36	96	72	3 to 1
49	32	13 3/8	42 3/8	3	3	12 1/2	4 1/2	12	60	36	96	75	3 to 1
53	34	14 1/2	46	6	6	13	5	15 1/2	60	36	96	78	3 to 1
60	38	16 1/2	51 1/2	6	6	14	5 1/2	21	60	36	96	84	3 to 1
68	43	18 1/2	58 1/2	6	6	16	6	25 1/2	60	36	96	90	3 to 1

DIMENSIONS OF PRECAST END SECTION FOR ROUND PIPE											
DIA.	K	J	C	D	E	T	R ₃	R ₄	R ₅	SLOPE	
IN.	IN.	IN.	IN.	IN.	IN.	IN.	IN.	IN.	IN.		
18	9	27	46	73	36	2 1/2	3	3	6	3 to 1	
24	9 1/2	43 1/2	30	73 1/2	48	3	3	3	7	3 to 1	
30	12	54	19 1/2	73 1/2	60	3 1/2	3	3	8	3 to 1	
36	15	63	34 1/2	97 1/2	72	4	3	3	10 1/2	3 to 1	
42	21	63	35	98	78	4 1/2	3	3	10 1/2	3 to 1	
48	24	72	26	98	84	5	6	6	14	3 to 1	

NOTE: DIMENSIONS SHOWN FOR PRECAST END SECTIONS ARE SUBJECT TO MANUFACTURES TOLERANCES.

GENERAL NOTES

- ALL CONSTRUCTION AND MATERIAL REQUIREMENTS SHALL BE IN ACCORDANCE WITH THE CURRENT STANDARD SPECIFICATIONS.
- WHEN CULVERT END SECTIONS ARE OPTIONAL THEY SHALL BE OF THE SAME MATERIAL AS THE PIPE ON WHICH THEY ARE INSTALLED. THE OPTIONAL PAYMENT SHALL BE FOR PREFAB. CULVERT END SECTION, ROUND OR ARCH.
- WHEN CULVERT PIPE IS SPECIFIED THE SECTION SHALL BE PAID FOR AS THE SAME TYPE (STEEL, ALUM., OR CONC.) AND SHAPE (ROUND OR ARCH.). IF ELLIPTICAL CONC. PIPE IS USED THE ELLIPTICAL END SECTION SHALL BE USED AND PAID FOR AS PREFAB CULVERT END SECTION, ARCH.
- TRENCH EXCAVATION REQUIRED FOR INSTALLATION OF CULVERT END SECTIONS SHALL BE INCLUDED IN THE PRICE BID FOR OTHER ITEMS OF WORK.

The City Of Enid
401 West Owen A. Corbett Road
Enid, Okla. 73703
Telephone: (800) 234-5000 Fax: (800) 234-8888

Contacts:

Robert Hitt, Director of Engineering Services, Ext. 344
Jason Britney, Civil Engineer, Ext. 348



The City Of Enid, Oklahoma

REVISIONS			
Number	Date	Description	Title Sheet
1	10/16/04		
2	5/7/00	Specification Number Change	

Project Number:	
Project Location:	

Sheet Title: **STANDARD PREFABRICATED CONCRETE CULVERT END SECTIONS**

Project Title: **DD - 7 SHT. 2**



Date:	8/1/01
Scale:	NO SCALE
Cad File:	0:\DATA\SPES\007
Drawn By:	P.B.
Designed By:	R.H.
Approved By:	R.H.
Sheet:	of